

CARE & COMPANY

ESTATE AGENTS • AUCTIONEERS • VALUERS

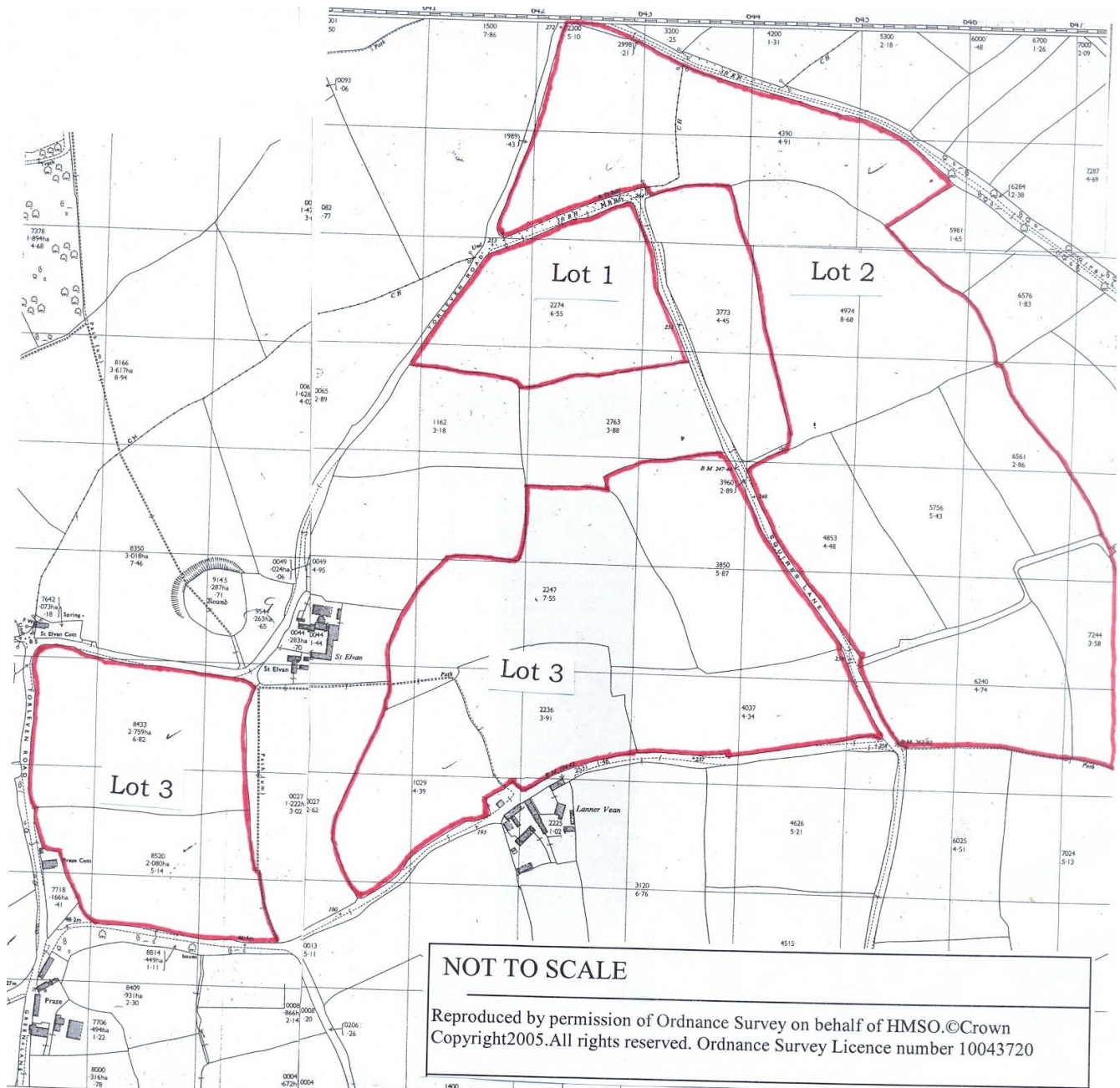

Highly productive agricultural land near Helston
extending in all to approximately 84.35 acres

**BEST & FINAL OFFERS INVITED BY 12 NOON
MONDAY 6th SEPTEMBER 2021**

Monument House, 58 Coinagehall Street, Helston, Cornwall TR13 8EW

Tel: 01326 565956

The Land in all extends to approximately 84.35 acres divided into three convenient lots. The land lies to the western side of Helston and is level and free draining and has the capability of producing a wide range and variety of crops. The freehold interest of the land is offered subject to full vacant possession upon completion.

Lot 1 – OS2274 (6.55a)

A single enclosure with access directly off Torleven Road.

Lot 2 – OS2300 (5.1a), 4390 (4.91a), 4974 (8.68a), 6561 (2.86a), 5756 (5.43a), 4853 (4.48a), 7244 (3.58a), 6240 (4.74a) totalling approximately 39.78 acres.

Lot 3 – OS3850 (5.87a), 2247 (7.55a), 4037 (4.34a), 2236 (3.91a), 1029 (4.39a), 8433 (6.82a), 8520 (5.14a) totalling approximately 38.02 acres.



**BEST & FINAL OFFERS ARE INVITED BY 12 NOON
MONDAY 6th SEPTEMBER. ALL OFFERS ARE TO BE
SUBMITTED IN WRITING TO THE SELLING AGENTS**

Viewing is strictly by appointment with

CARE & COMPANY

58 Coinagehall St, Helston. TR13 8EW

01326 565956

careandcompany@btconnect.com www.careandco.co.uk

AGENTS NOTES These particulars have been produced for general guidance only and the descriptions, measurements and photographs do not form part of any contract. All maps or extracts have been reproduced under Ordnance Survey Licence No. 100043720 and are not to scale or give any guarantee of boundaries or surroundings. No survey has been carried out on any part of the property or any testing of services, appliances or specific fittings or equipment, by the selling agents.