

# CARE & COMPANY

ESTATE AGENTS • AUCTIONEERS • VALUERS

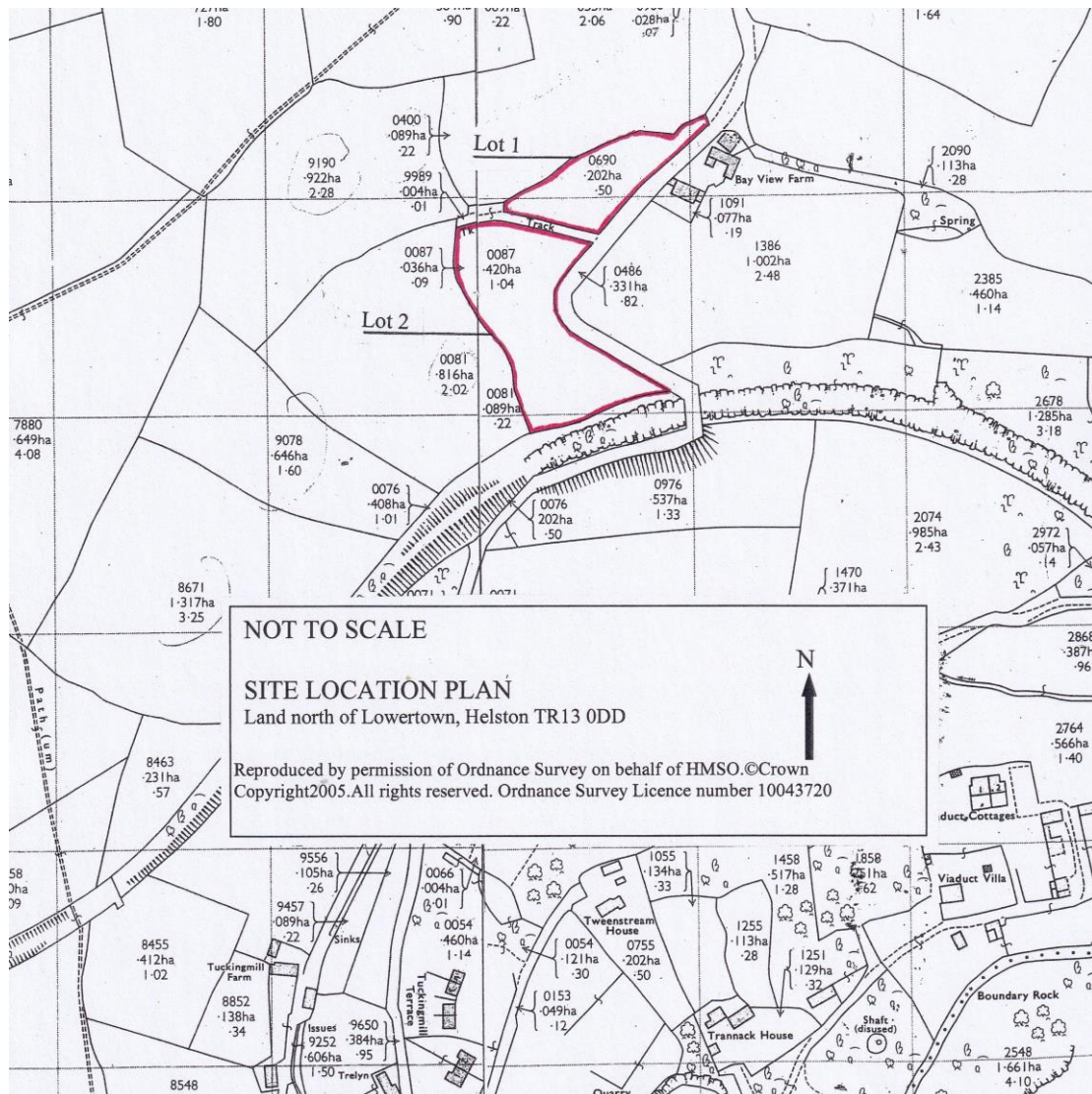

Land north of Lowertown, Helston TR13 0DD

Offered for sale in two Lots.

**Lot 1 – OS0690 Extending to approximately 0.50 acres currently laid to pasture.**

**Lot 2 – OS0087 Extending to approximately 1.13 acres currently laid to pasture.**

Monument House, 58 Coinagehall Street, Helston, Cornwall TR13 8EW

Tel: 01326 565956



## Land north of Lowertown, Helston TR13 0DD

The land is located to the northern side of Lowertown in a quiet rural location some one and a half miles from Helston town. Each enclosure is currently laid to pasture and has direct access to the adjoining adopted highway. Tenure : The land is freehold and is offered with full vacant possession.

Lot 1 – OS0690 Extending to approximately 0.50 acres currently laid to pasture.  
Price Guide £15,000 to £20,000



Lot 2 – OS0087 Extending to approximately 1.13 acres currently laid to pasture.  
Price Guide £25,000 to £30,000



### CARE & COMPANY

58 Coinagehall St, Helston. TR13 8EW

01326 565956 [careandcompany@careandco.co.uk](mailto:careandcompany@careandco.co.uk) [www.careandco.co.uk](http://www.careandco.co.uk)

**AGENTS NOTES** These particulars have been produced for general guidance only and the descriptions, measurements and photographs do not form part of any contract. All maps or extracts have been reproduced under Ordnance Survey Licence No. 100043720 and are not to scale or give any guarantee of boundaries or surroundings. No survey has been carried out on any part of the property or any testing of services, appliances or specific fittings or equipment, by the selling agents.